

Material	304 Stainless Steel
Unlock way	Card / Key / NFC
Key card Type	MF1 13.56MHz
Mortise	ANSI standard
Application	Hotel, Resort, Apartment, Commercial, Hospital, Education
Power Supply	4pcs AA Alkaline Batteries, 18 months duration(under normal state)
Certificates	UL,FCC, ROHS, ISO9001
Door Thickness Range	36-55mm
Opening Records	250pcs saving in lock, 240pcs can be downloaded and read
Working Humidity	20%-80%RH
Working Temperature	-10°C-60°C

Product advantage

1. NFC android phone install lock information rapidly
2. Anti-rusted, strong 304 handle, mortise coating with environment friendly material.
3. A wide range lock series, can satisfy demand of different project budget.
4. Completely independent research and development of Hardware and software. We offer SDK to be integrate with most of PMS basic on Windows.
5. Our products passed CE, FCC, UL fire-resistance tests.

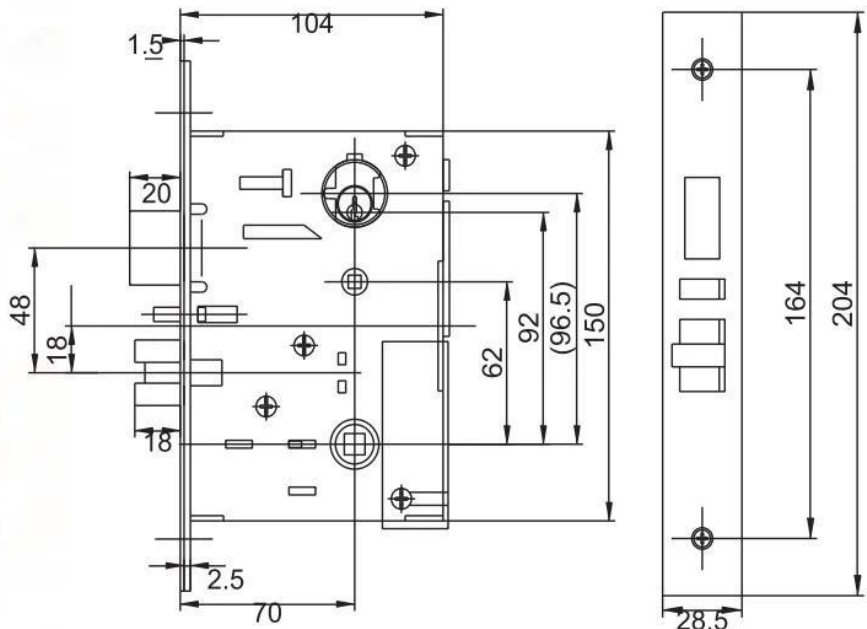

Mortise ANSI



Applicable card:	Temic, Mifare 1, EM/ID
Material:	Stainless steel 304
Mechanical key override:	Yes
Battery:	4 standard AA alkaline batteries, 18 months in normal state
Indication:	Light, Sound (Mute, Beep, or music optional)
Deadbolt Indication:	Blue and red light when touch key card
Unlocking record for trail:	Yes
Low voltage warning:	Yes
Passage mode for meeting room:	Yes
Static consumption:	12uA
Dynamic consumption:	300mA
Humidity:	20%-80%
Working temperature:	-10°C~60°C
Handle optional:	None, Client specified
Packing:	6PCS/CTN, 18.5KGS/CTN, 50.5*36*53CM



UL



CE



FCC



SGS



ATC



EN



Threading machine



Laser machine



Rivet driver



Drill



Auto soldering



Auto screwing



We strictly control the quality of our products via ISO90001 quality management system. Our smart locks have get through 300,000 times of unlocking tests by durability test machine imported from Germany. We have get the fireproof and theftproof certification by National Ministry of Public Security and CE、FCC and ROHS as well.

