

keyless access hotel rfid mifare card door lock key backup

material zinc alloy

Five bolts strong mortise

Mifare card to open the door

with mechanical keys for emergency

power supply is DC6V

By the card reader it can issue various series of different functions cards,such as floor card,guest card,building card,master card etc.

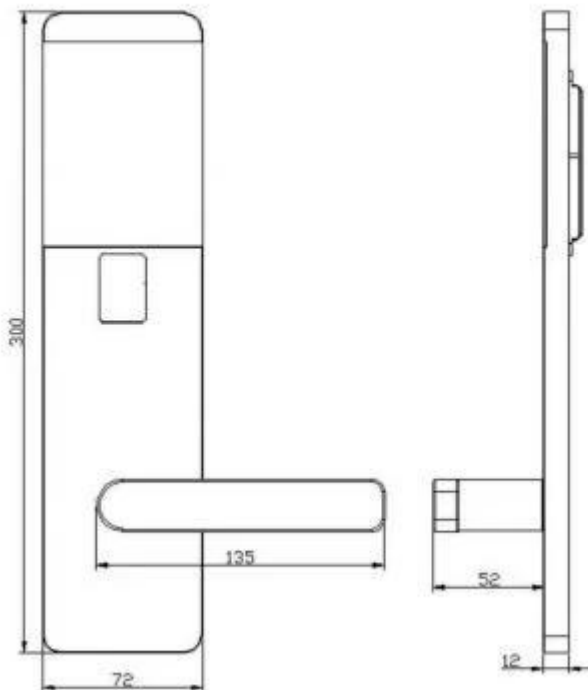

时间控制	刷卡功能	开锁记录	遗失挂失	级别限制	区域限制	密码控制	假锁报警
规定时间内才可开锁	刷卡未开门5S后自动上锁	可导出开锁记录 报表呈现分析	计算机可控制 遗失磁卡作废	不同的卡 不同的级别功能	固定楼层卡 只开固定楼层	所有卡为加密卡 核对正确才能开门	锁舌非正常压缩 自动发出滴滴声

技术参数

电子钥匙:	T5577卡 (M1、ID)
工作频率:	工作频率125~134.2KHZ
国标标准:	ISO1443-A
工作电压:	4节1.5V LR碱性电池
低压报警:	4.4V (±0.2V)
工作温度:	-25°C-55°C
工作湿度:	15%RH-93%RH
开门功耗:	≤200mA持续时间≤0.2S
机械寿命:	正常开门操作≥100000次
开锁记录:	可储存350条
开锁方式:	刷卡、钥匙

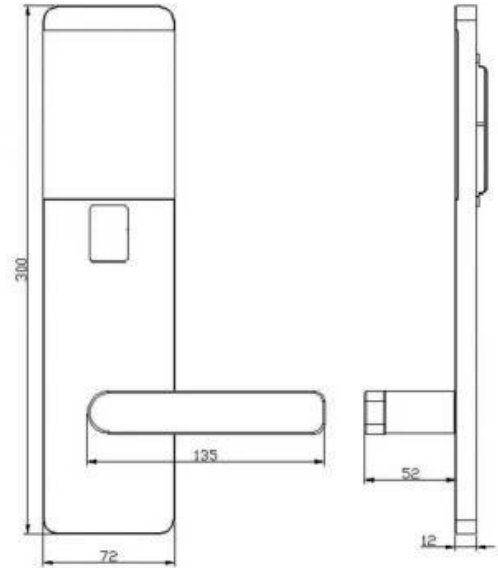



The direction of the door

When you standing outside of the door

A.(Left push)

B.(Right push)

C.(Left pull)

D.(Right pull)



A

Left Handle (push)

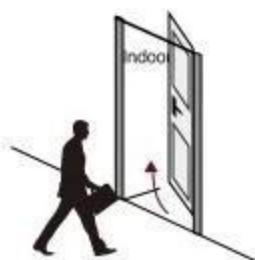

B

Righ Handle (push)



C

Left Handle (pull)



D

Right Handle (pull)

Building/Guestroom Information Settings

Buildings List

Building No.	Building Name
1	Hotel A
3	3

- Add Building
- Delete Building
- Modify Building
- Add Guestroom
- Delete Guestroom
- Modify Guestroom

X Exit

Guestrooms List---Hotel A

Floor No.	Guestroom No.	Type	Price	Hour Rate Start-up	Hour Rate Price	Status	Ma
1	102	Standard	100	24	20	Guest	2
1	103	Standard	100	24	20	Guest	2
1	101	VIP	123	30	50	Guest	2
2	202	VIP	123	30	50	Vacancy	2
2	203	Standard	100	24	20	Vacancy	4

Our Workshop





Our Warehouse





■ 2#短锁芯

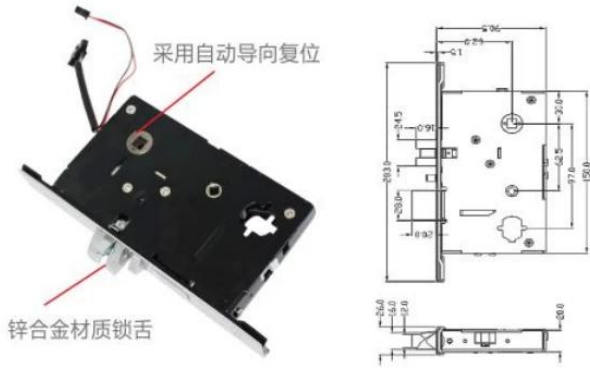

■ 2#长锁芯



■ 1#短锁芯

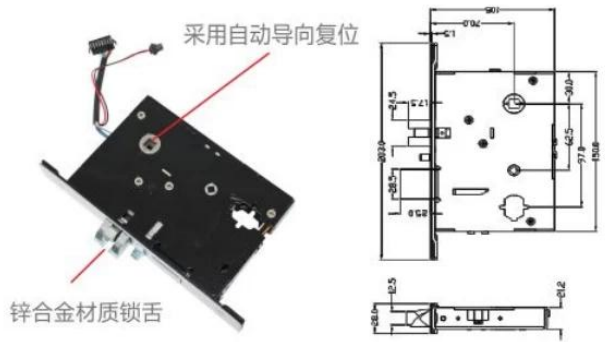

■ 1#长锁芯

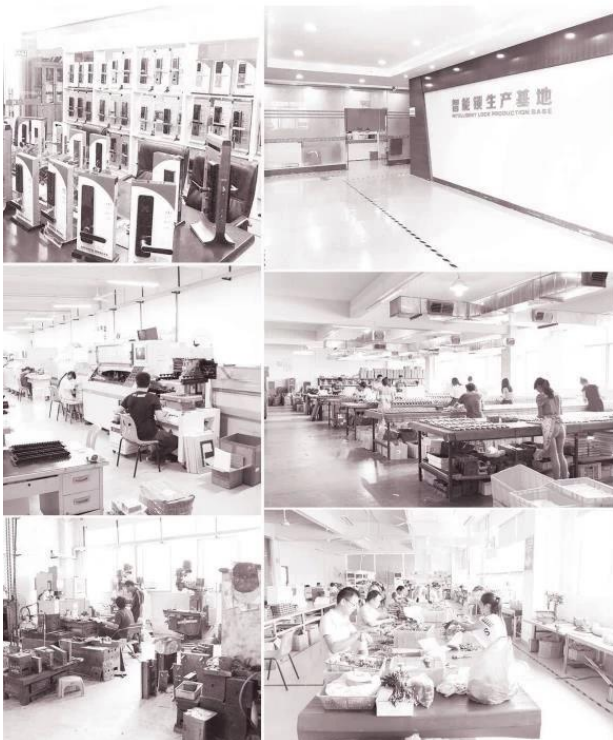
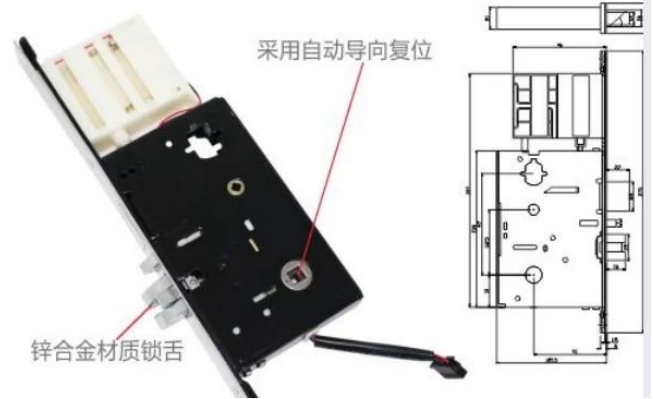



Our Projects



新沂经开区人才公寓



通辽内蒙古大学



鄂尔多斯市熙尔登酒店



邢台东方骏景大酒店



深圳保利来国际大酒店



深圳南方联合大酒店



江苏南通格林豪泰酒店



河北保定大梦酒店



深圳华侨城海洋广场



四川成都金地地产



河北省第六人民医院



大庆摩玛休闲广场